

Product End of Life Instructions

FBM216 - CHANNEL ISOLATED 8 ANALOG INPUT REDUNDANT

Analog Input, output modules with HART





End of Life Instructions

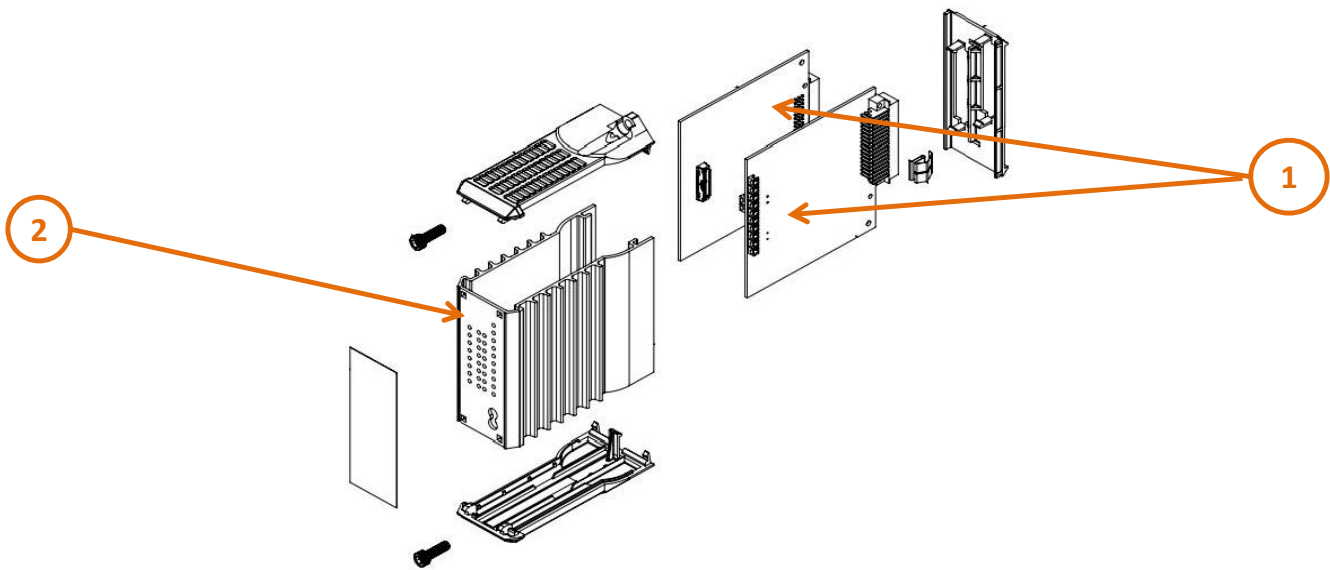

Recommendation	Number on drawing	Component / Material	Weight (in g)	Comment
To be depolluted	1	Electronic Board (Communication) > 10cm ²	111.3	
To be dismantled	2	Aluminium	132.4	
Other		Plastics and Other parts	50	



Product description

Manufacturer identification	Schneider Electric Industries SAS
Brand name	Foxboro DCS
Product function	Analog Input module with HART and 4-20 mA support, common isolated power supply to channels and redundancy support when used in pairs
Product reference	P0922VV
Additional similar product references	P0922VV FBM216 FBM214 P0914SY P0922VT P0922VU
Total representative product mass	284 g
Representative product dimensions	114 mm(H) x 45 mm(L) x 104 mm(D)
Accessories	No accessories needed
Date of information release	04/2021